

# FDA 510K Cleared

## DOA Rapid Test Cup

**CLIA Waived  
(510K No.: K241428)**

- Amphetamine (AMP) - 500 ng/mL
- Barbiturate (BAR) - 300 ng/mL
- Benzodiazepine (BZO) - 300 ng/mL
- Buprenorphine (BUP) - 10 ng/mL
- Cocaine (COC) - 150 ng/mL
- Marijuana (THC) - 50 ng/mL
- Methadone (MTD) - 300 ng/mL
- Methamphetamine (MET) - 500 ng/mL
- Ecstasy (MDMA) - 500 ng/mL
- Morphine (MOP) - 300 ng/mL
- Phencyclidine (PCP) - 25 ng/mL
- Tricyclic Antidepressants (TCA) - 1000 ng/mL
- Oxycodone (OXY) - 100 ng/mL
- Fentanyl (FYL) - 1 ng/mL**

### Product Advantages

- ◆ Accurate Results
- ◆ Convenient Procedure
- ◆ Fast Results in 5 minutes
- ◆ Temp strip on cup
- ◆ Click Locking Lid



### Convenient Procedure

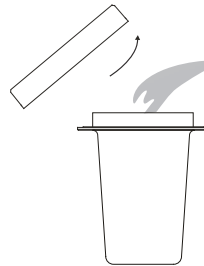

- Open the cap and add specimen.
- Specimen volume must exceed the minimum line.

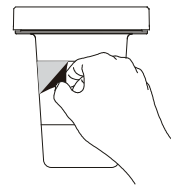

- Peel off the label to view results

1

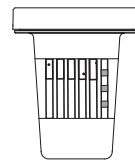

Cup with adulteration

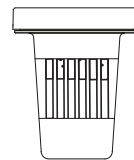

Cup without adulteration

Interpret adulteration strips between 3-5 minutes. See enclosed color chart for interpretation.

	No adulteration	Adulteration
AD1		
AD2		
AD3		
AD4		
AD5		
AD6		

Read Drug Result at 5 minutes.

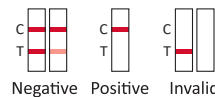

2

### Ordering Information

Cat.No	Product	Specimen	Format	Pack	Certification
DT-AT12-1-AZ25	DrugTect Multi-Drug Rapid Urine Test Cup	Urine	1 Step Cup	25 T	USFDA CLIA Waived
DT-AT14-AD6-1-AZ25	DrugTect Multi-Drug Rapid Urine Test Cup with Adulteration (CR, GL, PH, NI, OX, SG)	Urine	1 Step Cup	25 T	USFDA CLIA Waived